

Hypertech Inline Speedometer Calibrator Module Installation instructions 730110 Ford F-150

Tools Needed: 7mm Socket, Trim removal tools (optional)

Be advised: These instructions may not include specifics for all vehicle configurations.

1. Program the Speedometer Calibrator Module
2. Set Parking brake
3. Separate the upper portion of the lower Instrument Panel Cover



- a. Carefully, with fingers or trim removal tool, separate ONLY the upper portion of the Panel. The key is to expose the (7mm) screws highlighted below.

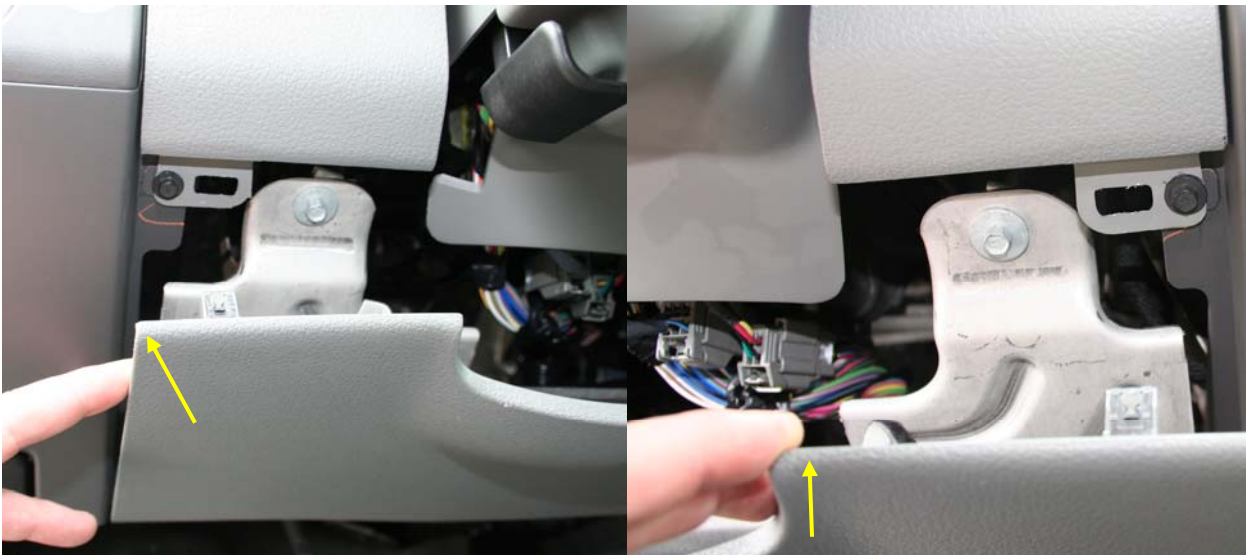

4. Remove the Upper Instrument Panel Bezel
 - a. Using the 7mm socket, remove the (2) screws, which retain the Upper Instrument Panel Bezel.
 - b.



- c. Work along each side, separating the bezel from the dash, remove and place out of the way.



5. Connect the Inline Module

a. Disconnect the Electrical Connector

- i. Do not remove the Instrument Panel Cluster. As you can see, the connector, on the left-hand side of the cluster is the one to disconnect. Referring to the top left of the Instrument Panel Cluster. While looking at the connector, you will see a grey lever. Press the button, and pull the lever up and to the left at the same time. After the lever is pulled back, the connector should easily release from the Instrument Panel.



- b. Connect (C3) of the supplied harness to the Inline Control Module.
- c. As in the photo below, (C2) of the inline harness should have a header with pins installed. Orient and connect (C2) to the factory harness connector as in the following photo.



- d. Using the supplied Velcro hook and latch, refer to the following photo and bind the two connectors together.

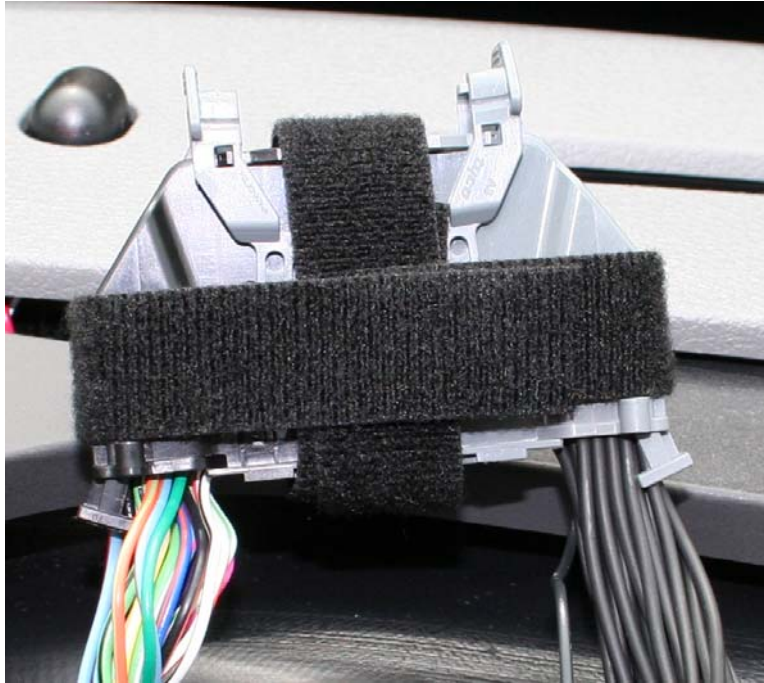

- e. Using the supplied harness connector (C1), orient it as in the following photo, and plug it into the Instrument Panel Cluster.



6. Carefully stow the associated hardware, and reverse the process of this document to properly re-install the Instrument Panel components.